

Connecting the Projector to the Tablet using Wireless Dongle



Before initiating the process, switch on the Projector power, In case everything is OK with the Projector and Wireless Dongle above screen will be displayed by the Projector

Connecting screen can be initiated using two (02) methods

Method 01: Using Settings Menu

Step 01: Click on Settings icon on Home Screen to access the Settings menu

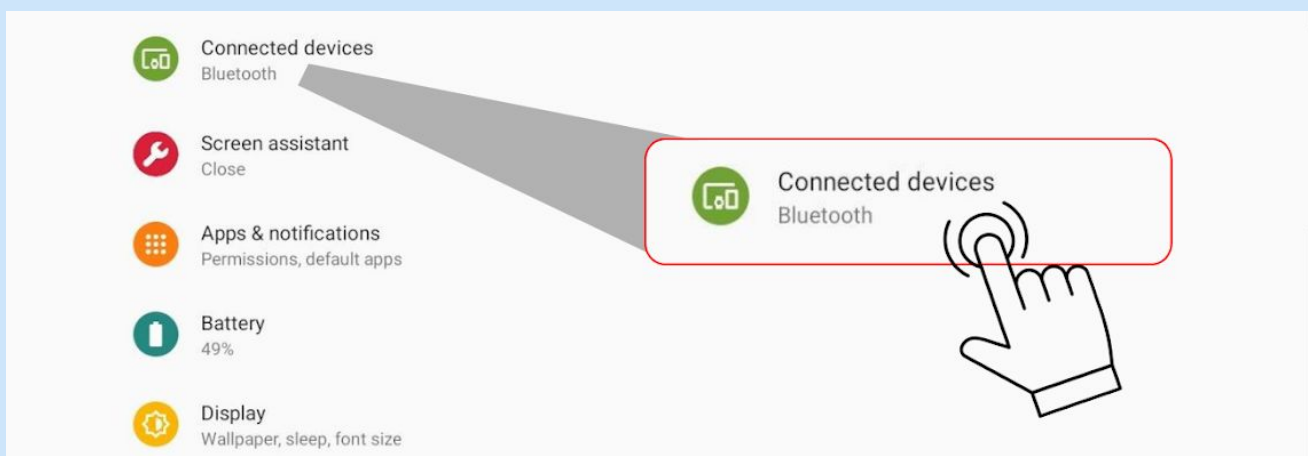

Step 02: Click on the Connected devices icon (By default Bluetooth option is shown for Connected devices)

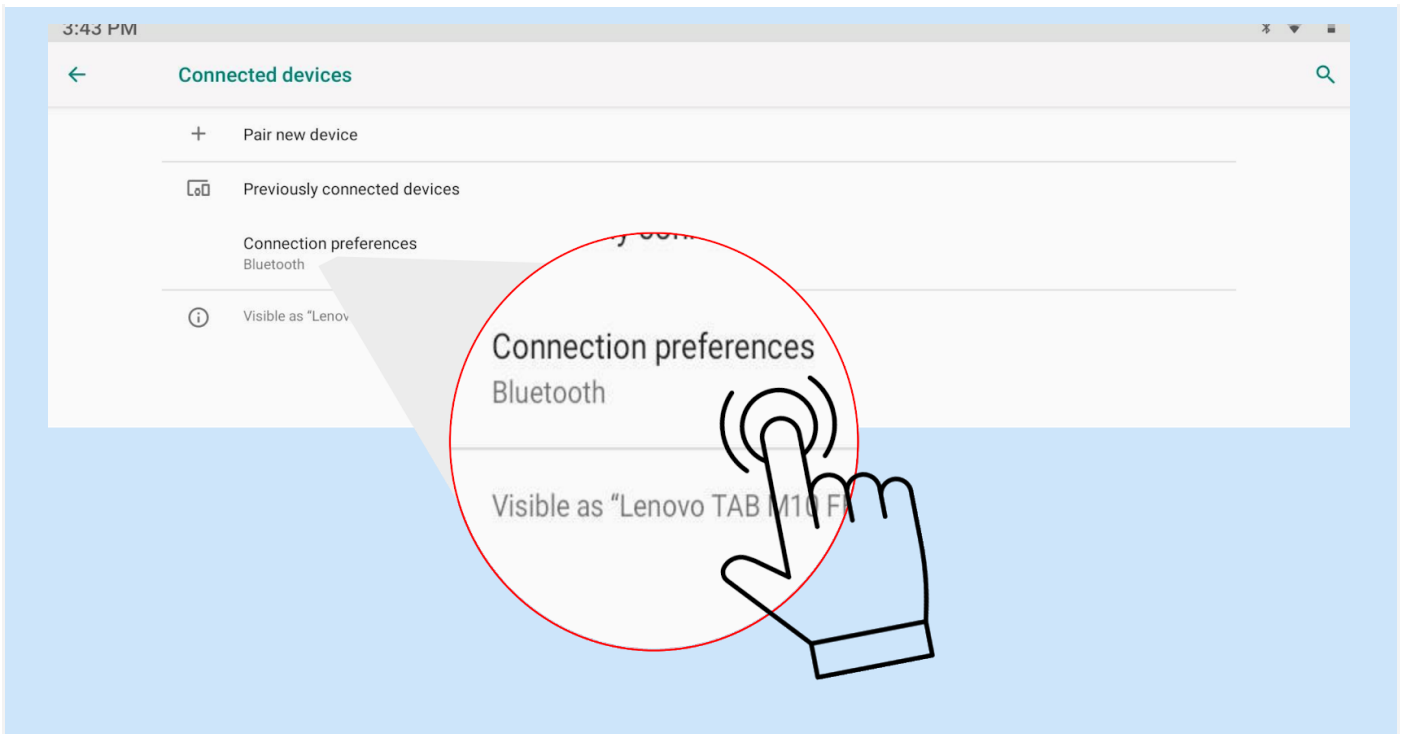

Step 03: Click on the Connection preferences to select Cast from the list of preferences

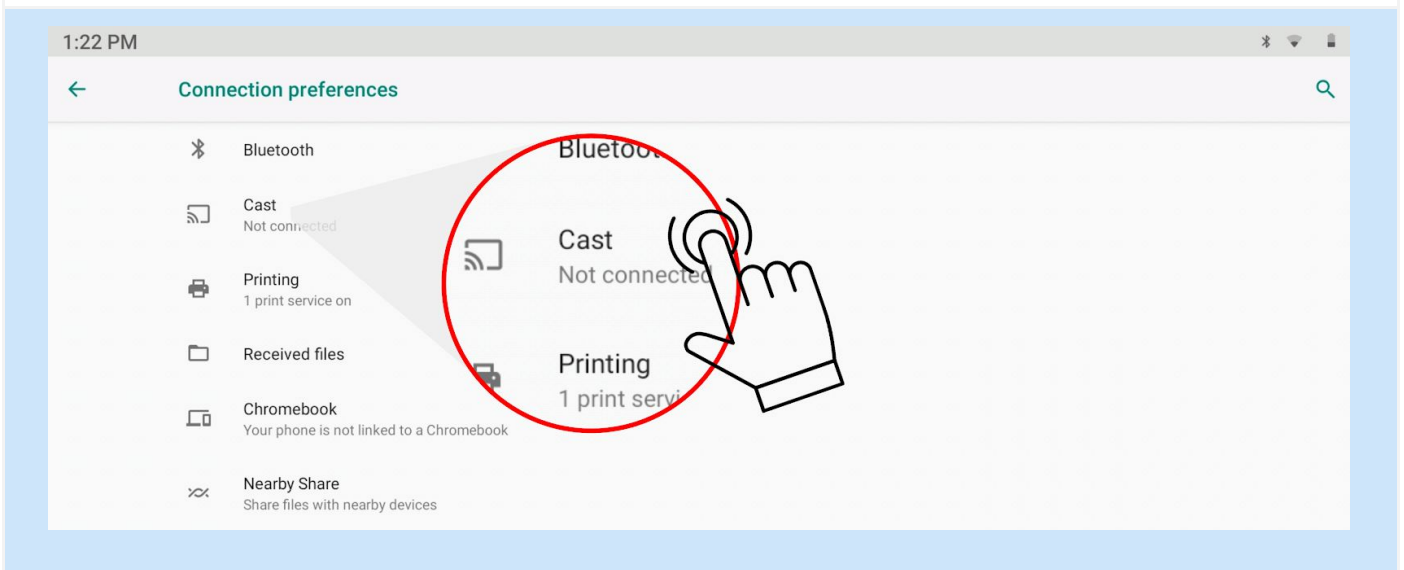

Step 04: Click on Cast to access the settings

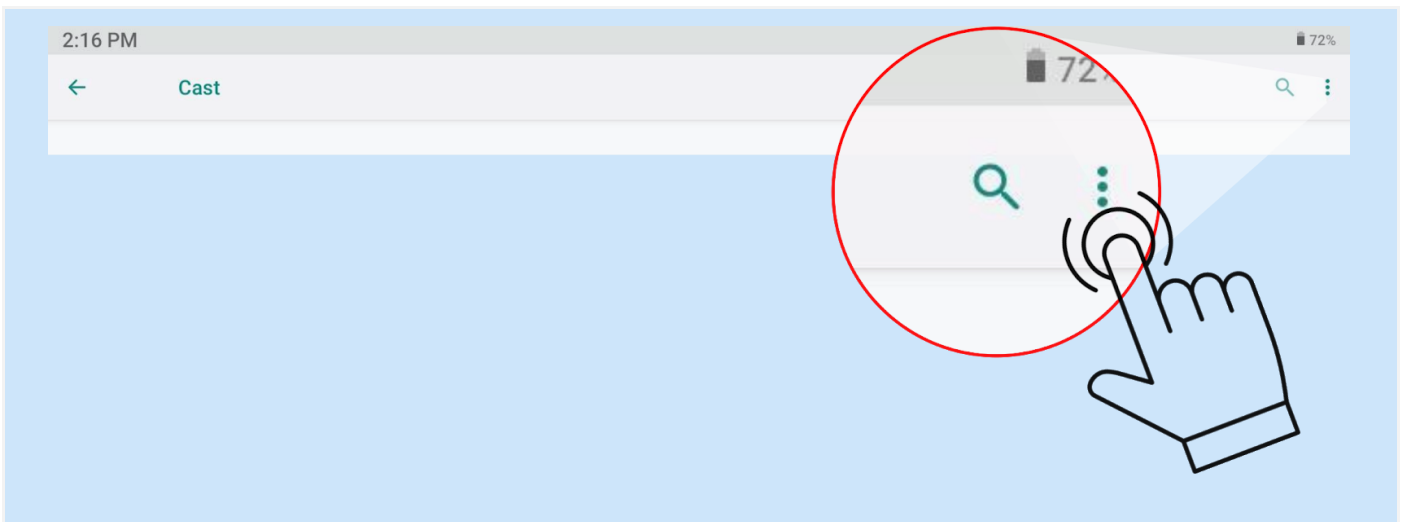

Step 05 - Click on three dots to get Enable wireless display

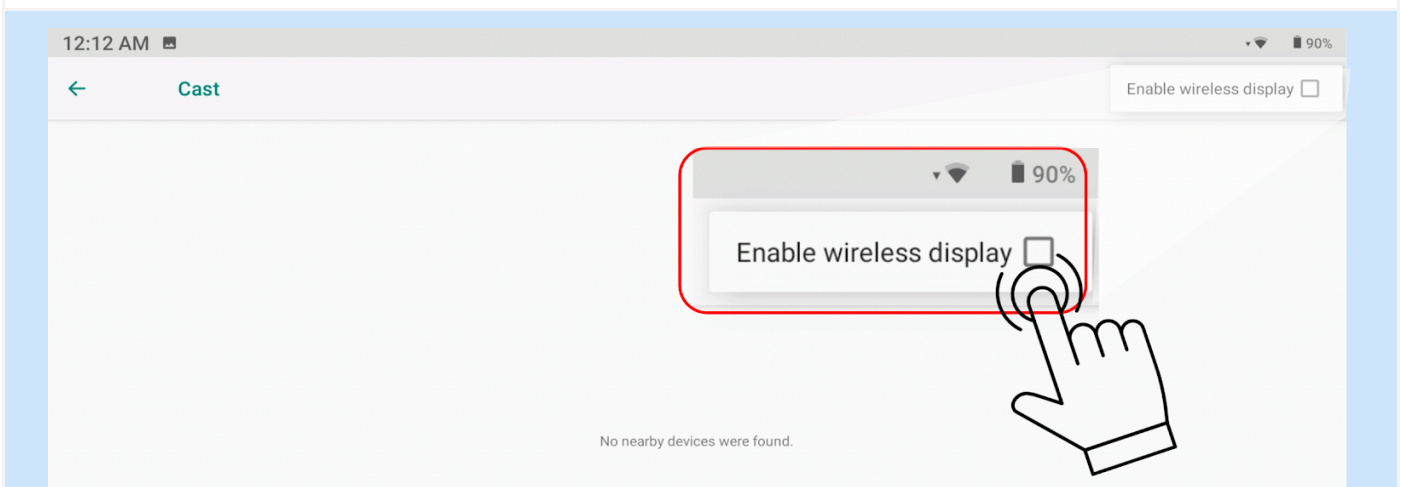

Step 06: Check Enable wireless display option

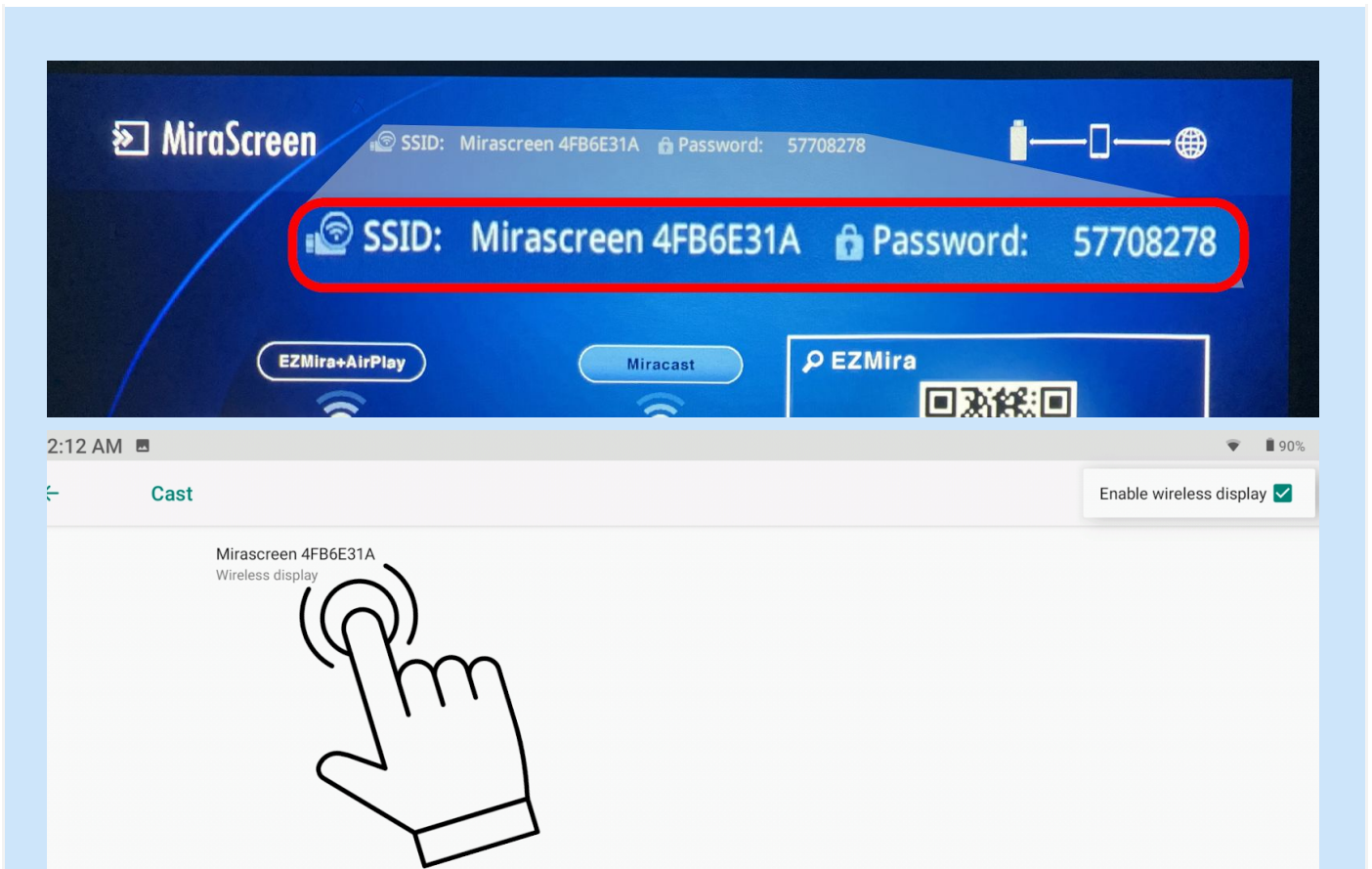

Step 07: Wireless Dongles within the access are displayed, Click on the Wireless Dongle that matches with the SSID displayed on the screen projected by the Projector.

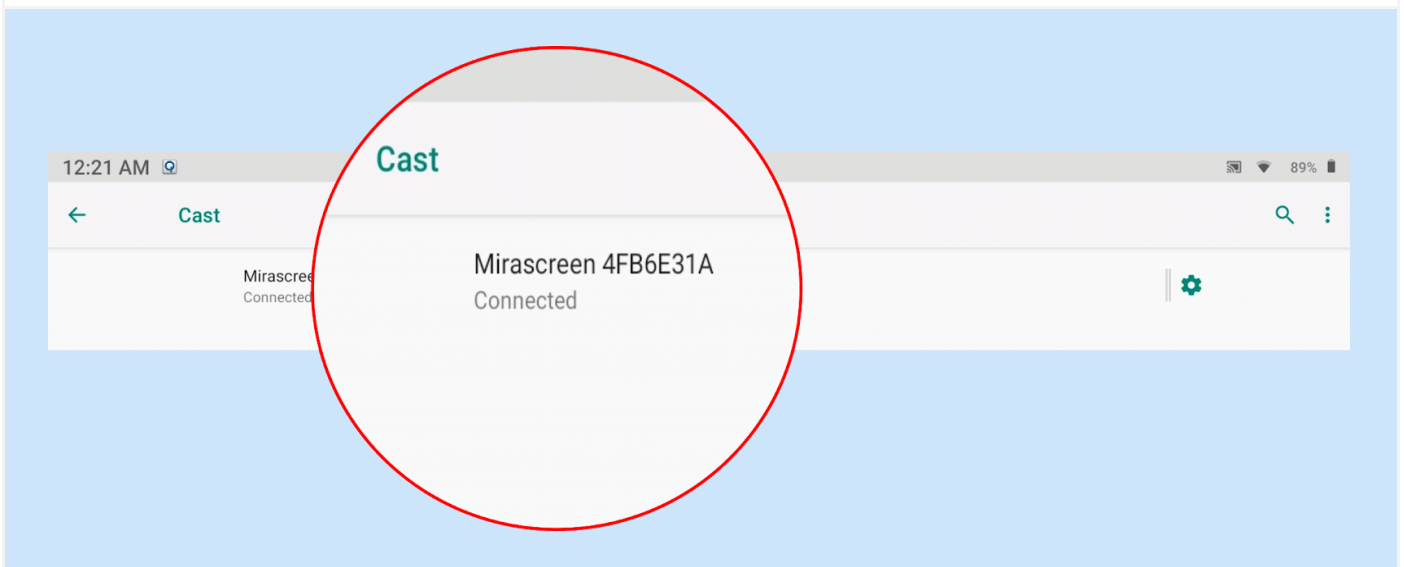

The Wireless Dongle is connected, screen casting is activated.

Method 02: Using Active Tiles on Notification Menu

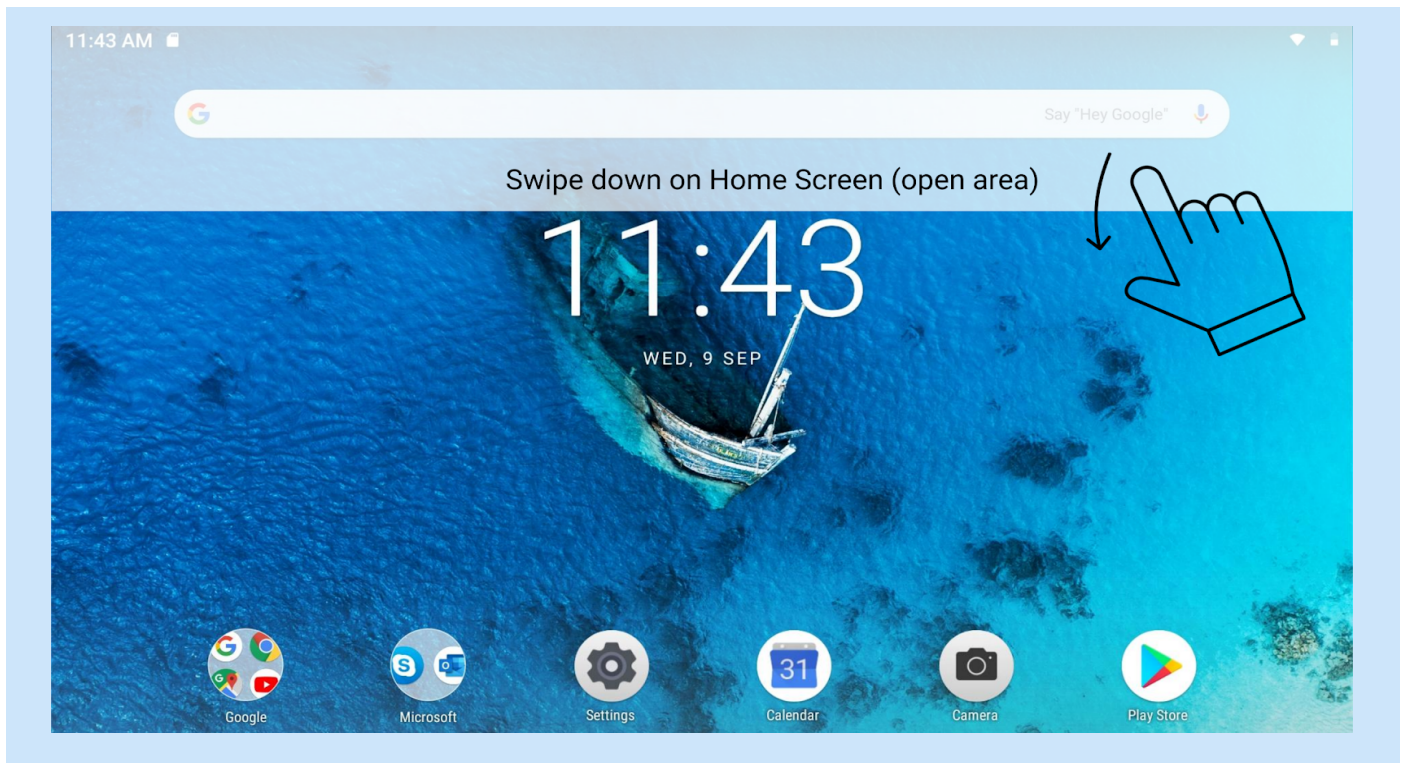

Step 01: Swipe down in the open area of Home Screen to access Notification Menu

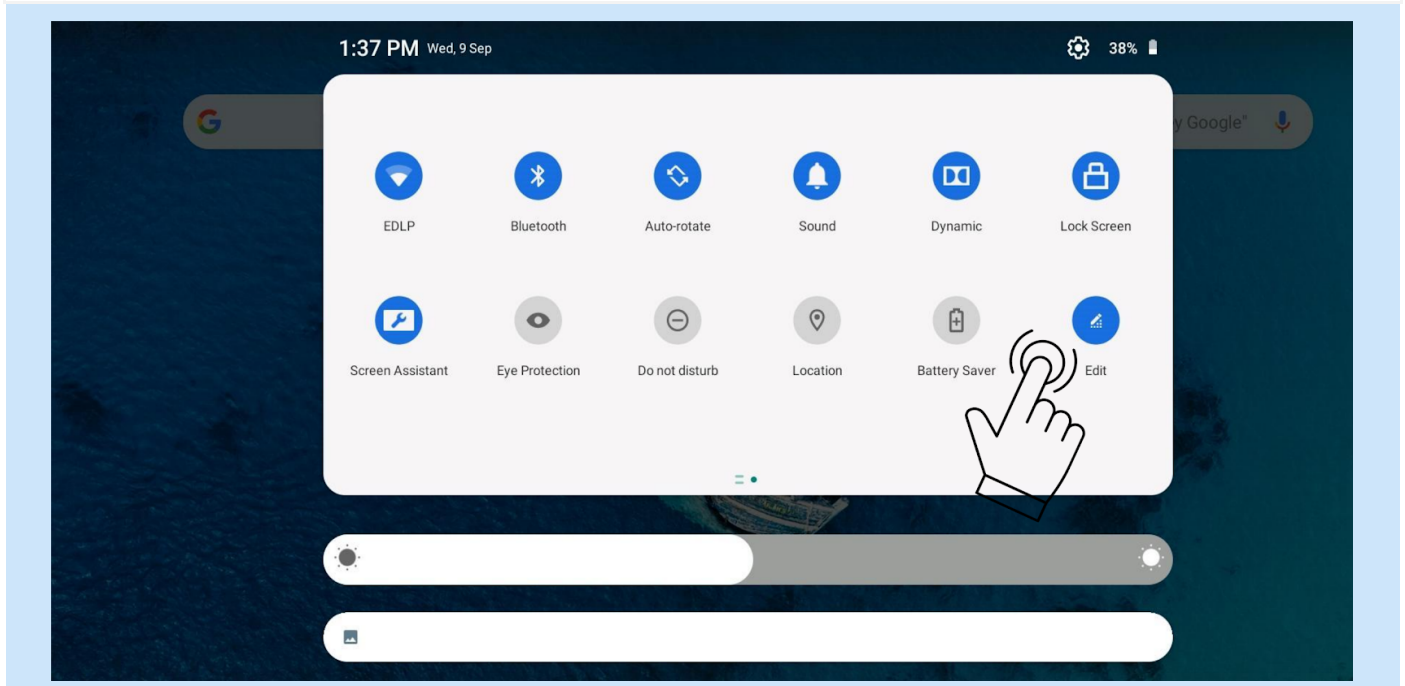

Step 02: Click Edit to view all the Tiles available in Notification menu.

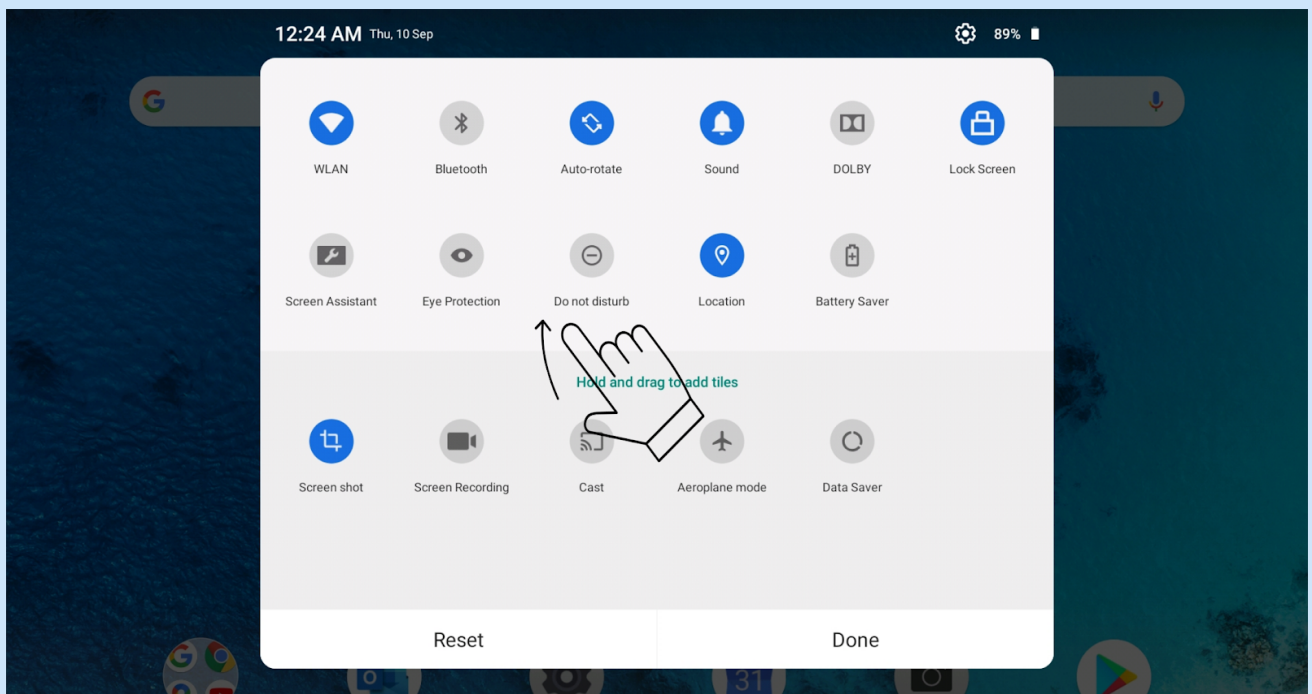

Step 03: Drag Cast icon to active window and Click done

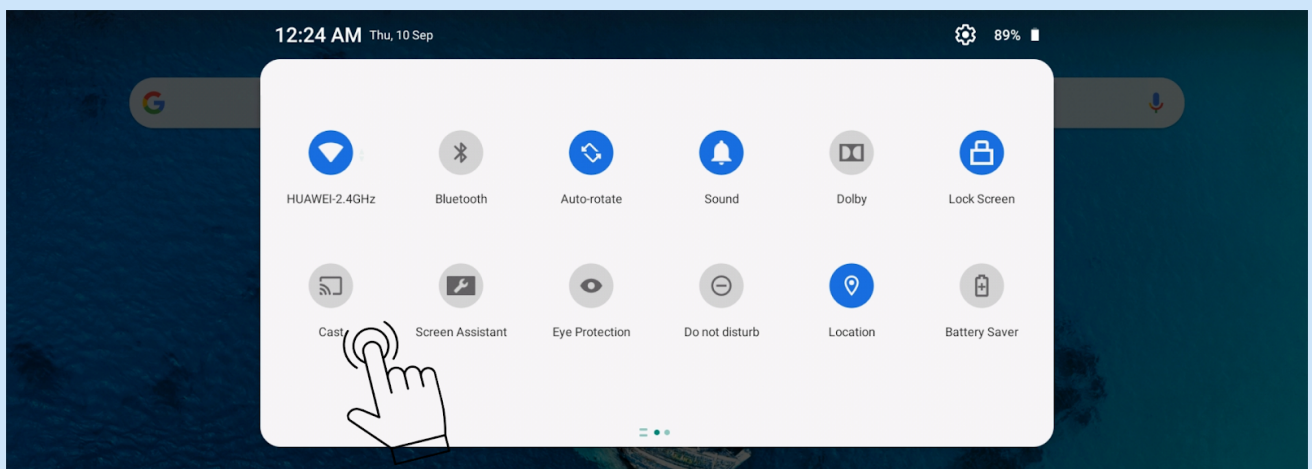

Step 04: Cast icon is added in the active window, Click on Cast

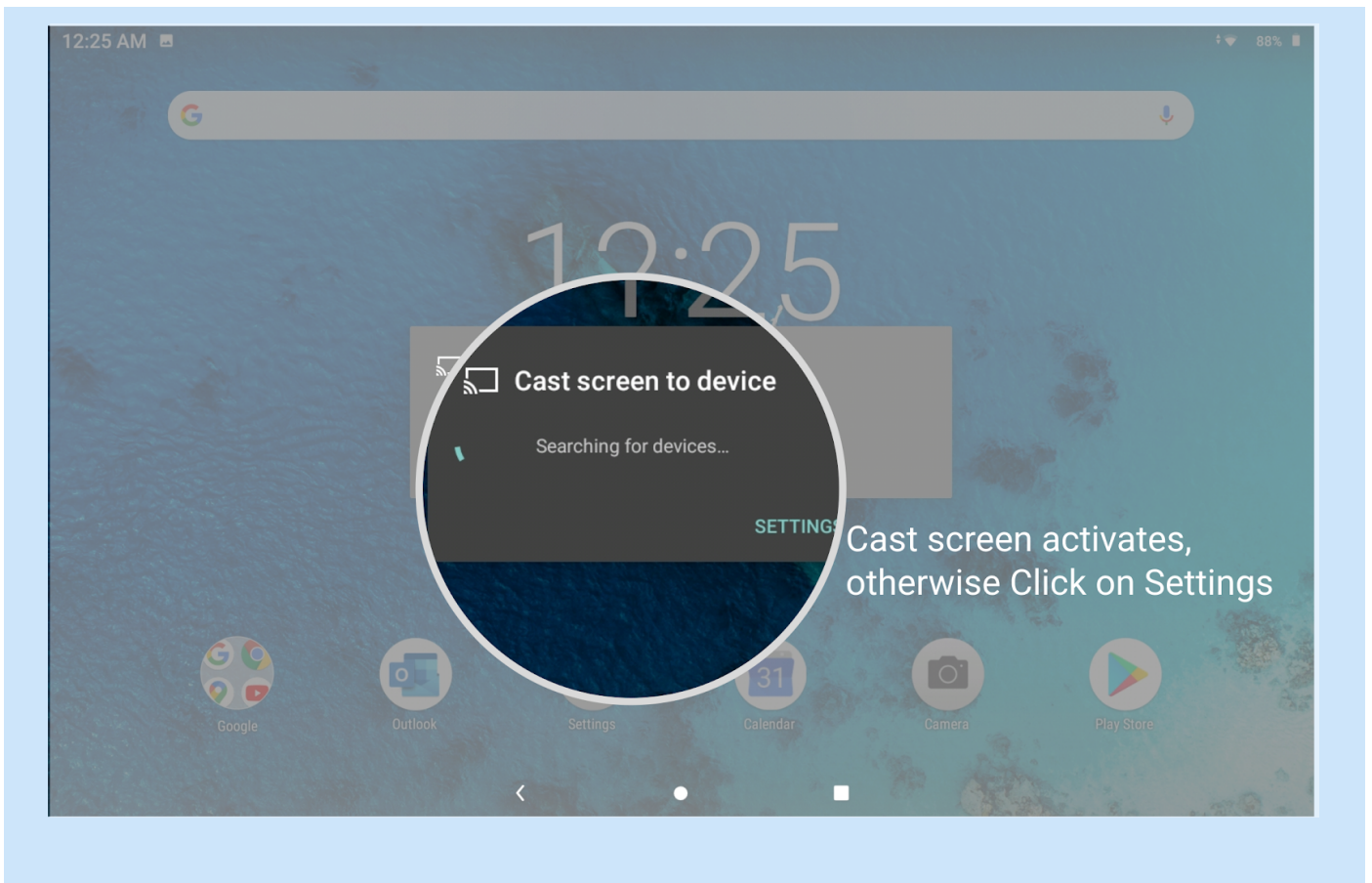

Step 05: Cast screen to device activates, click Settings and follow steps from Method 01 Step 02 to connect to Wireless Dongle